

Community Hospital of the Monterey Peninsula

23625 Holman Highway, Monterey, CA
(831) 624-5311 | www.chomp.org

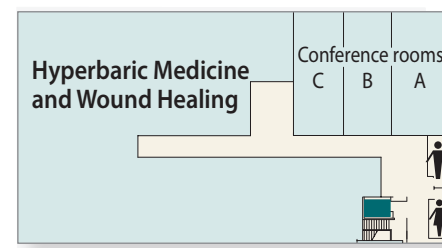

Roof Level (Above Main Level)

Above Outpatient Surgery Center

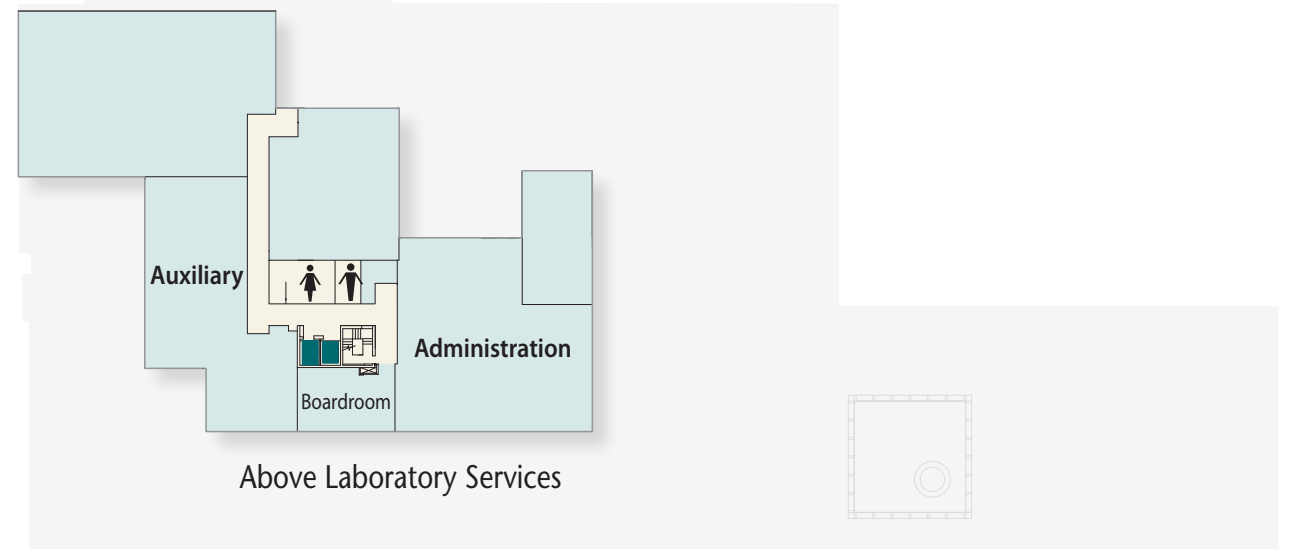

Above Laboratory Services

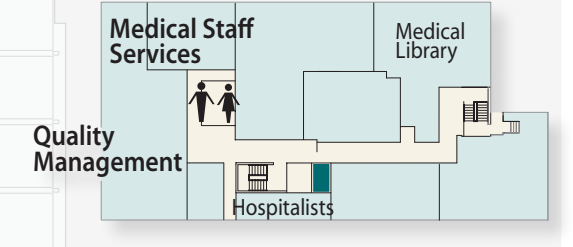

Above Diagnostic and Interventional Radiology

Main Level



Garden Level (Below Main Level)

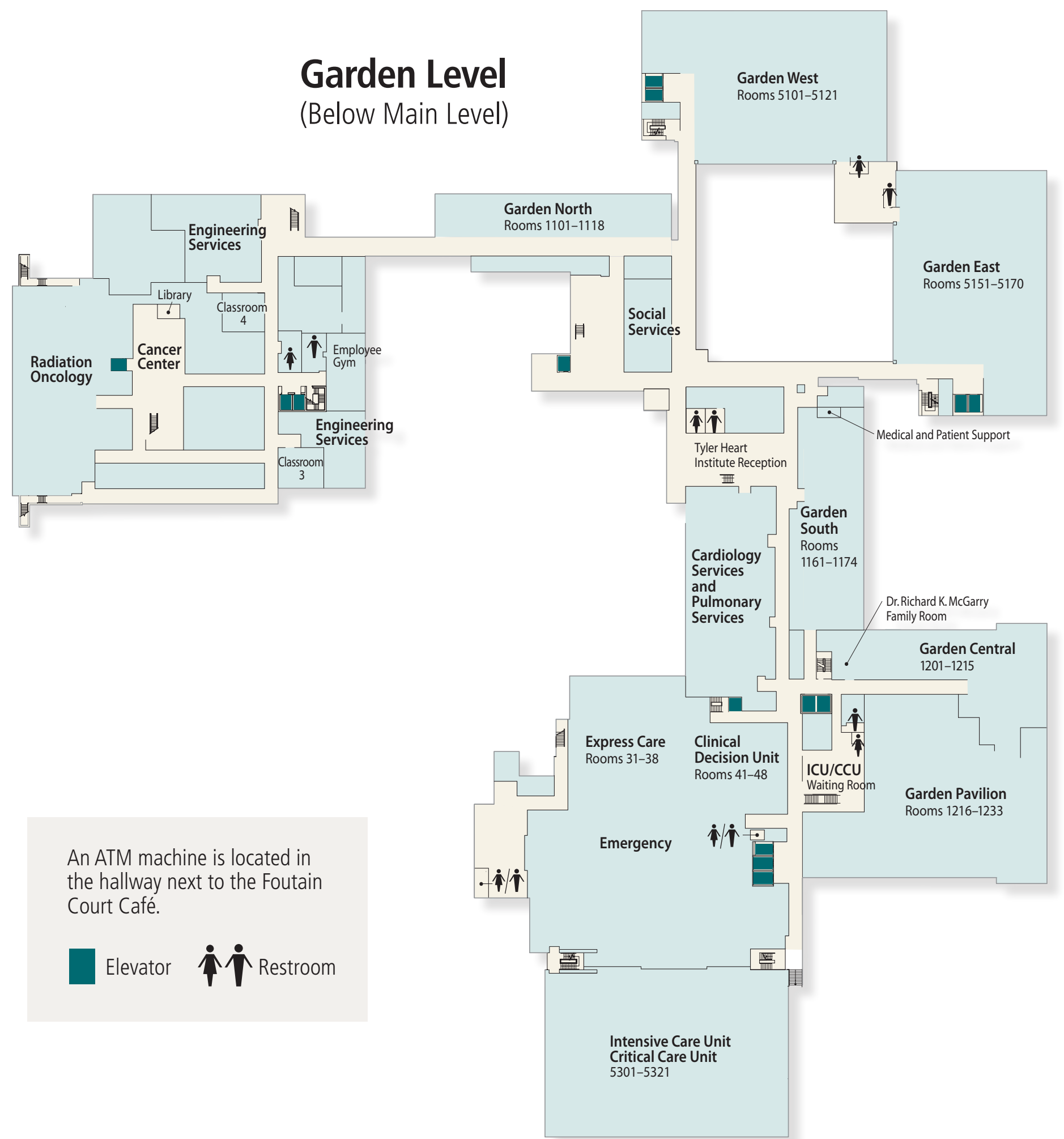

Terrace Level (Below Garden Level)

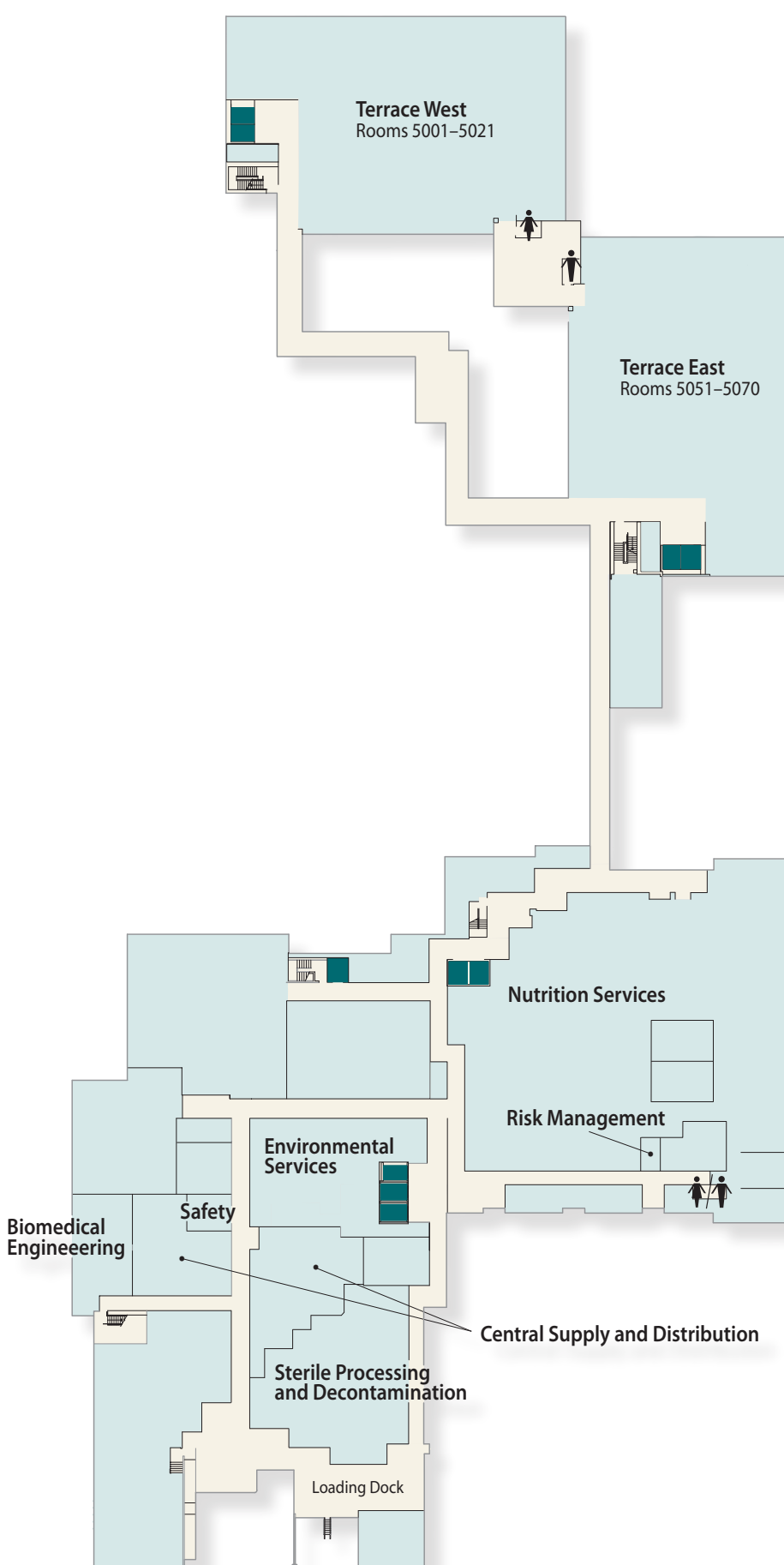

An ATM machine is located in the hallway next to the Fountain Court Café.

Elevator Restroom